

**NOTICE!!**

**These documents have been scanned!**

**Do not place un-scanned documents beneath this notice!**

**Do not remove this notice from this file!**

GPO Jacket No. 560-102  
Print Order 61540  
Rise Business Services, LLC  
Job=AZ15 5/10/2019



Box Number= AZ15030



Claim Begin-End: AMC430297-AMC430300

1 Initial Receipt



AZ15030-31

AMC429998-AMC430297



**United States Department of the Interior**  
**Bureau of Land Management**  
 LANDS/RECREATION & PLANNING  
 ONE N CENTRAL AVE  
 PHOENIX, AZ 85004 -2203  
 Phone: 602-417-9200

Receipt

No: 3213834

<b>Transaction #:</b> 3307539	
<b>Date of Transaction:</b> 01/22/2015	
CUSTOMER:	
EVRIM RESOURCES USA INC 6121 LAKESIDE DR STE 260 RENO,NV 89511 US	

**ENTERED**  
 FEB 17 2015  
 BY: RAM

LINE #	QTY	DESCRIPTION	REMARKS	UNIT PRICE	TOTAL
1	4.00	LOCATABLE MINERALS / MINING CLAIMS-NEW,UNADJUD, ONE OR MORE AUTH NOS / NEW MINING CLAIMS LOCATION FEE <b>CASES:</b> AMC430297/\$37.00, AMC430298/\$37.00, AMC430299/\$37.00, AMC430300/\$37.00		- n/a -	148.00
2	4.00	LOCATABLE MINERALS / MINING CLAIMS-NEW,UNADJUD, ONE OR MORE AUTH NOS / NEW MINING CLAIM PROCESSING FEE <b>CASES:</b> AMC430297/\$20.00, AMC430298/\$20.00, AMC430299/\$20.00, AMC430300/\$20.00		- n/a -	80.00
3	4.00	LOCATABLE MINERALS / MINING CLAIMS-NEW,UNADJUD, ONE OR MORE AUTH NOS / NEW MINING CLAIMS MAINTENANCE FEE <b>CASES:</b> AMC430297/\$155.00, AMC430298/\$155.00, AMC430299/\$155.00, AMC430300/\$155.00		- n/a -	620.00
<b>TOTAL:</b>					<b>\$848.00</b>

PAYMENT INFORMATION			
1	AMOUNT:	848.00	POSTMARKED: N/A
	TYPE:	CHECK	RECEIVED: 01/21/2015
	CHECK NO:	1544	
	NAME:	ALMAR PROFESSIONAL LAND SERVICES INC 450 HILLS DR #A-160 MESQUITE NV 89027 US	

REMARKS

This receipt was generated by the automated BLM Collections and Billing System and is a paper representation of a portion of the official electronic record contained therein.



**NOTICE!!**

**These documents have been scanned!**

**Do not place un-scanned documents beneath this notice!**

**Do not remove this notice from this file!**

GPO Jacket No. 560-102  
Print Order 61540  
Rise Business Services, LLC  
Job=AZ15 5/10/2019



Box Number= AZ15030



Claim Begin-End: AMC430297-AMC430300

2 Correspondence



AZ15030-31

AMC429998-AMC430297



# United States Department of the Interior



## BUREAU OF LAND MANAGEMENT

Arizona State Office

One North Central Avenue, Suite 800

Phoenix, Arizona 85004-4427

[www.blm.gov/az/](http://www.blm.gov/az/)

NOV 14 2016

In Reply Refer To:

3800 (9200) RE

AMC429591, AMC430297

CERTIFIED MAIL - RETURN RECEIPT REQUESTED No. 7016 2070 0000 4805 7731

### DECISION

NOEL COUSINS : This decision affects those claims shown  
PO BOX 37061 : in the block below.  
TUCSON, AZ 85740-7061 :

---

AMC429595, AMC429596, AMC429598, AMC429599, AMC429601, AMC429604, AMC429605,  
AMC430300

ARDMORE #105, ARDMORE #106, ARDMORE #108, ARDMORE #109, ARDMORE #131,  
ARDMORE #134, ARDMORE #135, ARDMORE #114

---

### MINING CLAIMS DECLARED FORFEIT

The mining claims listed above have been declared forfeit as of September 1, 2016, for failure to timely file the required maintenance fee payment or small miner's maintenance fee waiver (waiver).

Claimants are required to pay an annual non-refundable maintenance fee of \$155 per 20 acres or portion thereof, or submit a waiver, on or before September 1 of each year. These requirements were established by 30 U.S.C. 28f-1, as amended, and 43 CFR 3834 and 3835.

Our records do not show receipt of a maintenance fee payment or small miner waiver filed on or before the due date. Therefore, the claims listed above are forfeit.

### Reclamation Requirements

This decision does not relieve you of the liability for reclamation of all areas disturbed by your activities on lands covered by the subject mining claim(s) and/or site(s). After you complete the reclamation, you must notify the authorized officer of the appropriate surface managing agency so that the authorized officer may conduct a final site inspection and determine whether you may be released from liability. If you fail to reclaim the land to the satisfaction of the authorized officer, the surface management agency may cite you for noncompliance under its surface management regulations. For land administered by the Bureau of Land Management (BLM), if you fail to

reclaim the land to the satisfaction of the authorized officer as required in 43 CFR Subpart 3809, BLM will issue an order of noncompliance under 43 CFR 3809.601(a). If you fail to comply with the non-compliance order, BLM may take further action under 43 CFR 3809.604. Failure to conduct reclamation is a prohibited act that may subject you to criminal penalties. See 43 CFR 3809.605(h) and 43 CFR 3809.700.

### Appeal Procedures

This decision may be appealed to the Interior Board of Land Appeals, Office of the Secretary, in accordance with the regulations contained in 43 CFR, Part 4, and the enclosed Form 1842-1. If an appeal is taken, your notice of appeal must be filed in this office (at the above address) within 30 days from receipt of this decision. The appellant has the burden of showing that the decision appealed from is in error.

If you wish to file a petition pursuant to regulation 43 CFR 4.21 (58 FR 4939, January 19, 1993) for a stay of the effectiveness of this decision during the time that your appeal is being reviewed by the Board, the petition for a stay must accompany your notice of appeal. A petition for a stay is required to show sufficient justification based on the standards listed below. Copies of the notice of appeal and petition for a stay **must** also be submitted to each party named in this decision and to the Interior Board of Land Appeals and to the appropriate Office of the Solicitor (see 43 CFR 4.413) at the same time the original documents are filed with this office. If you request a stay, you have the burden of proof to demonstrate that a stay should be granted.

### Standards for Obtaining a Stay

Except as otherwise provided by law or other pertinent regulation, a petition for a stay of a decision pending appeal shall show sufficient justification based on the following standards:

- (1) The relative harm to the parties if the stay is granted or denied,
- (2) The likelihood of the appellant's success on the merits,
- (3) The likelihood of immediate and irreparable harm if the stay is not granted, and
- (4) Whether the public interest favors granting the stay.

Please include your AMC serial number(s) on all correspondence. If additional information is required, please call Rod Ebert at 602-417-9397.



Rebecca Heick  
Deputy State Director  
Lands, Minerals, and Energy Division

Enclosure



SENDER: COMPLETE THIS SECTION

COMPLETE THIS SECTION ON DELIVERY

Complete items 1, 2, and 3.

Print your name and address on the reverse so that we can return the card to you.

Attach this card to the back of the mailpiece, or on the front if space permits.

Article Addressed to:

NOEL COUSINS  
PO BOX 37061  
TUCSON AZ 85740-7061  
920/RE/AMC429591, AMC430297

A. Signature

X *[Signature]*  Agent  
 Addressee

B. Received by (Printed Name)

*Noel Cousins*

C. Date of Delivery

D. Is delivery address different from item 1?  Yes  
If YES, enter delivery address below:  No

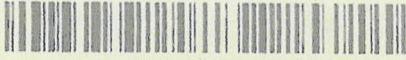

9590 9402 1933 6123 0049 74

Article Number (Transfer from service label)

7016 2070 0000 4805 7731

3. Service Type

- Adult Signature
- Adult Signature Restricted Delivery
- Certified Mail®
- Certified Mail Restricted Delivery
- Collect on Delivery
- Collect on Delivery Restricted Delivery
- Mail Restricted Delivery
- Priority Mail Express®
- Registered Mail™
- Registered Mail Restricted Delivery
- Return Receipt for Merchandise
- Signature Confirmation™
- Signature Confirmation Restricted Delivery

Form 3811, July 2015 PSN 7530-02-000-9053

Domestic Return Receipt

USPS TRACKING #



9590 9402 1933 6123 0049 74

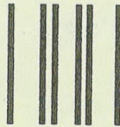

First-Class Mail  
Postage & Fees Paid  
USPS  
Permit No. G-10

United States  
Postal Service

• Sender: Please print your name, address, and ZIP+4® in this box®

UNITED STATES  
DEPARTMENT OF THE INTERIOR  
Bureau of Land Management  
Arizona State Office  
One N. Central Avenue, Suite 800  
Phoenix, AZ 85004-4427

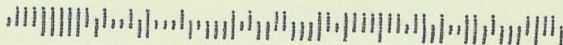





# United States Department of the Interior



BUREAU OF LAND MANAGEMENT

Arizona State Office

One North Central Avenue, Suite 800

Phoenix, Arizona 85004-4427

[www.blm.gov/az/](http://www.blm.gov/az/)

**AUG 17 2016**

In Reply Refer To:

3800 (9200) IO

AMC429591; AMC430297

CERTIFIED MAIL – RETURN RECEIPT REQUESTED 7015 1660 0000 0271 8334

## NOTICE

EVIM RESOURCES USA INC  
6121 LAKESIDE DR STE 260  
RENO, NV 89511

:  
:  
:

This Decision Affects Those Claims  
Shown in the Block Below.

---

AMC429591-AMC429605; AMC430297-AMC430300

ARDMORE #101; ARDMORE #102; ARDMORE #103; ARDMORE #104; ARDMORE #105;  
ARDMORE #106; ARDMORE #107; ARDMORE #108; ARDMORE #109; ARDMORE #110;  
ARDMORE #111; ARDMORE #112; ARDMORE #113; ARDMORE #114; ARDMORE #131;  
ARDMORE #132; ARDMORE #133; ARDMORE #134; ARDMORE #135

---

### Transfer(s) Not Processed

A conveyance document to transfer ownership of the mining claim(s) listed above was received by the Bureau of Land Management (BLM) Arizona State Office. The transfer(s) of ownership cannot be processed for the following reason(s):

We received your request to process a Quitclaim Deed for 19 transfers. The processing fee for a transfer of interest is \$10 per claim, per each grantee. A payment of \$190 was received for one grantee but there is a shortage of \$190 for the other grantee that is required to complete the transfer of interests.

If appropriate, please submit a corrected conveyance document, required documents, or additional fees, within 30 days of your receipt of this notice. If the required information is not received within the 30-day timeframe, no further action will be taken, and the BLM will retain the non-refundable processing fees submitted.

If additional information is required, please contact Iran Ortega at 602-417-9355. Please include your AMC serial number(s) on all correspondence.

*Rebecca Heick*

Rebecca Heick  
Deputy State Director  
Lands, Minerals and Energy Division

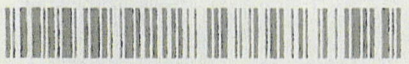

SENDER: COMPLETE THIS SECTION	COMPLETE THIS SECTION ON DELIVERY
<ul style="list-style-type: none"> <li>■ Complete items 1, 2, and 3.</li> <li>■ Print your name and address on the reverse so that we can return the card to you.</li> <li>■ Attach this card to the back of the mailpiece, or on the front if space permits.</li> </ul>	<p>A. Signature <span style="float: right;"><input type="checkbox"/> Agent <input type="checkbox"/> Addressee</span></p> <p>B. Received by (Printed Name) <span style="float: right;">C. Date of Delivery</span></p>
<p>1. Article Addressed to:</p> <p><b>EVRIM RESOURCES USA INC</b>  <b>6121 LAKESIDE DR STE 260</b>  <b>RENO NV 89511</b>  <b>920/10/AMC429591;</b>  <b>AMC430297</b></p>	<p>D. Is delivery address different from item 1? <input type="checkbox"/> Yes  If YES, enter delivery address below: <input type="checkbox"/> No</p>
 <p>9590 9401 0166 5234 4571 36</p> <p>2. Article Number (Transfer from service label)</p> <p><b>7015 1660 0000 0271 8334</b></p>	<p>3. Service Type <span style="float: right;"><input type="checkbox"/> Priority Mail Express® <input type="checkbox"/> Registered Mail™</span></p> <p><input type="checkbox"/> Adult Signature <span style="float: right;"><input type="checkbox"/> Registered Mail Restricted Delivery</span></p> <p><input type="checkbox"/> Adult Signature Restricted Delivery <span style="float: right;"><input type="checkbox"/> Registered Mail Restricted Delivery</span></p> <p><input checked="" type="checkbox"/> Certified Mail® <span style="float: right;"><input checked="" type="checkbox"/> Return Receipt for Merchandise</span></p> <p><input type="checkbox"/> Certified Mail Restricted Delivery <span style="float: right;"><input checked="" type="checkbox"/> Signature Confirmation™</span></p> <p><input type="checkbox"/> Collect on Delivery <span style="float: right;"><input type="checkbox"/> Signature Confirmation Restricted Delivery</span></p> <p><input type="checkbox"/> Collect on Delivery Restricted Delivery <span style="float: right;"><input type="checkbox"/> Signature Confirmation Restricted Delivery</span></p>
<p>PS Form 3811, July 2015 PSN 7530-02-000-9053 <span style="float: right;">Domestic Return Receipt</span></p>	

**USPS TRACKING#**

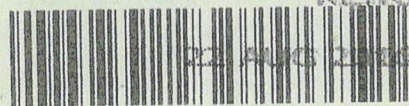
9590 9401 0166 5234 4571 36

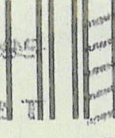

First-Class Mail  
Postage & Fees Paid  
USPS  
Permit No. 940

RECEIVED  
BLM AZ STATE OFF  
2016 AUG 25  
PHOENIX, ARIZONA

Sender: Please print your name, address, and ZIP+4® in this box®

**UNITED STATES**  
**DEPARTMENT OF THE INTERIOR**  
**Bureau of Land Management**  
**Arizona State Office**  
**One N. Central Avenue, Suite 800**  
**Phoenix, AZ 85004-4427**

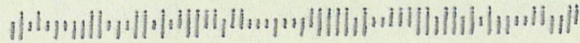

**NOTICE!!**

**These documents have been scanned!**

**Do not place un-scanned documents beneath this notice!**

**Do not remove this notice from this file!**

GPO Jacket No. 560-102  
Print Order 61540  
Rise Business Services, LLC  
Job=AZ15 5/10/2019



Box Number= AZ15030



Claim Begin-End: AMC430297-AMC430300

3 Transfers



AZ15030-31

AMC429998-AMC430297





**DeCONCINI McDONALD YETWIN & LACY**  
A PROFESSIONAL CORPORATION  
ATTORNEYS AT LAW

2525 EAST BROADWAY BOULEVARD • SUITE 200 • TUCSON, ARIZONA 85716-5300  
(520) 322-5000 • (520) 322-5585 (FAX)

429591  
430297

DMYL.COM

DENISE M. BAINTON  
ALICE W. CALLISON  
BARRY M. COREY  
JODY A. CORRALES  
PETER B. GOLDMAN  
NATHAN B. HANNAH  
STEVEN J. ITKIN  
JAMES A. JUTRY  
JOHN C. LACY  
ZELMA LETARTE  
KATHRYN B. NELSON

RYAN D. O'NEAL  
ALEXIA J. PETERSON  
JOHN C. RICHARDSON  
LISA ANNE SMITH  
SPENCER A. SMITH  
SESALY O. STAMPS  
JAMES M. SUSAN  
PAUL M. TILLEY  
MEGAN J. TROG  
GARY F. URMAN  
MICHAEL R. URMAN

**FIRM FOUNDERS:**  
EVO A. DeCONCINI (1901-1986)  
JOHN R. McDONALD (1933-2012)  
DENNIS W. DeCONCINI

**PHOENIX OFFICE:**  
7310 NORTH 16TH STREET, SUITE 330  
PHOENIX, ARIZONA 85020  
(602) 282-0500  
FAX: (602) 282-0520

**OF COUNSEL:**  
RICHARD M. YETWIN  
BARRON & ASSOCIATES, P.C. - JOHN H. BARRON, III

August 2, 2016

PLEASE REPLY TO TUCSON  
KSMITH@DMYL.COM

Bureau of Land Management  
Arizona State Office  
One North Central Ave.  
Phoenix, AZ 85004

**Re: Notice of Transfer of Interest**

Ladies and Gentlemen:

Notice is hereby given pursuant to 43 C.F.R. § 3833.32(b) that, by the enclosed Mining Deed dated June 22, 2016, has transferred its interest in Evrim Resources USA patented lode/placer mining claims (the "Claims") to Noel Cousins, an unmarried man, and Steve Van Ert, an unmarried man.

1. The Claims transferred are in Pinal County, Arizona, the names of which and the serial numbers assigned to each claim are set forth in Exhibit A of the enclosed Mining Deed.
2. The name and address to which the claims have been transferred is:  
  
Noel Cousins and Steven Van Ert  
P.O. Box 37061  
Chatsworth, CA 91313
3. A check in the amount of \$190.00 is enclosed to cover the fee for the transfer of 19 claims as indicated on the table at 43 C.F.R. § 3830.21.

Sincerely,

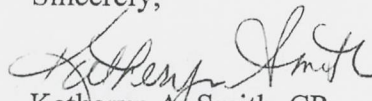
  
Katheryn A. Smith, CP  
Certified Paralegal

Encl.

c w/encs: Noel Cousins  
Steve Van Ert

RECEIVED  
BLM AZ STATE OFFICE  
2016 AUG -4 P 2:35  
PHOENIX, ARIZONA

3



OFFICIAL RECORDS OF  
PINAL COUNTY RECORDER  
VIRGINIA ROSS

When recorded, return to:  
John C. Lacy  
DeConcini McDonald Yetwin & Lacy, P.C.  
2525 E. Broadway Blvd., Suite 200  
Tucson, Arizona 85716

DATE/TIME: 07/12/2016 1103  
FEE: \$15.00  
PAGES: 3  
FEE NUMBER: 2016-045291



Exempt per A.R.S. § 11-1134.A.6

**MINING DEED**

**FOR GOOD AND VALUABLE CONSIDERATION**, the receipt and sufficiency of which are hereby expressly acknowledged, **EVIM RESOURCES USA INC.**, a Nevada corporation ("Grantor"), whose address is 6121 Lakeside Drive., Suite 260, Reno, Nevada 89511-8534, does, subject to the paramount right and title of the United States of America and the limitations under the General Mining Law, hereby conveys to **NOEL COUSINS**, an unmarried man, and **STEVEN VAN ERT**, an unmarried man (collectively the "Grantee"), whose address is P.O. Box 37061, Chatsworth, California 91313, the following described unpatented lode mining claims situated in the Black Mountain Mining District, Pinal County, Arizona (the "Property"), the names of which mining claims, the place of record of the location notices thereof in the official records of Pinal County and the serial numbers assigned by the Arizona State Office of the Bureau of Land Management, are set forth in Exhibit A attached hereto and made a part hereof.

**TOGETHER WITH** any and all extralateral and other associated rights, water rights, tenements, hereditaments and appurtenances thereto belonging, or otherwise appertaining thereto.

**IN WITNESS WHEREOF**, Grantor has executed this Mining Deed on this 22<sup>nd</sup> day of June, 2016.

**GRANTOR:**

**EVIM RESOURCES USA INC.**

By: *S. Van Ert*

Its:

RECEIVED  
BLM AZ STATE OFFICE  
2016 AUG -4 P 2:36  
PHOENIX, ARIZONA

PROVINCE BRITISH COLUMBIA  
STATE OF \_\_\_\_\_ )

County of VANCOUVER )

ss.

On this, the 22<sup>nd</sup> day of June, 2016, before me, the undersigned Notary Public, personally appeared STEWART HARRIS, the VP TECHNICAL SERVICES of EVRIM RESOURCES USA INC, a Nevada corporation, known to me to be the person whose name is subscribed to the foregoing instrument and acknowledged that he/she executed the same on behalf of the corporation for the purposes therein contained.

IN WITNESS WHEREOF, I hereunto set my hand and official seal.

\_\_\_\_\_  
Notary Public

My Commission Expires:  
\_\_\_\_\_

ALAN J. HUTCHISON  
Barrister & Solicitor  
DENTONS CANADA LLP  
20th Floor, 250 Howe Street  
Vancouver, B.C. V6C 3R8  
Telephone (604) 687-4460

RECEIVED  
BIM AZ STATE OFFICE  
2016 AUG - 4 P 2:36  
PHOENIX, ARIZONA

## EXHIBIT A

The "Property" consists of those certain unpatented lode mining claims situated in the Black Mountain Mining District, in Sections 9, 15 and 16 of Township 8 South, Range 14 East, G&SR Mer., Pinal County, Arizona, the names of which and the place of record of the location notices thereof in the official records of the county recorder and the authorized office of the Bureau of Land Management are as follows:

<b>Name of Claim</b>	<b>County Records Fee Number</b>	<b>BLM Serial # AMC</b>
ARDMORE #101	2014-071788	429591
ARDMORE #102	2014-071789	429592
ARDMORE #103	2014-071790	429593
ARDMORE #104	2014-071791	429594
ARDMORE #105	2014-071792	429595
ARDMORE #106	2014-071793	429596
ARDMORE #107	2014-071794	429597
ARDMORE #108	2014-071795	429598
ARDMORE #109	2014-071796	429599
ARDMORE #110	2014-071797	429600
ARDMORE #111	2015-005476	439297
ARDMORE #112	2015-005477	430298
ARDMORE #113	2015-005478	430299
ARDMORE #114	2015-005479	430300
ARDMORE #131	2014-071798	429601
ARDMORE #132	2014-071799	429602
ARDMORE #133	2014-071800	429603
ARDMORE #134	2014-071801	429604
ARDMORE #135	2014-071802	429605

I:\FILES\DOCS\VANE03\100805\DOC\1052428.DOC

RECEIVED  
BLM AZ STATE OFFICE  
2016 AUG -4 P 2:36  
PHOENIX, ARIZONA



DECONCINI McDONALD YETWIN & LACY  
A PROFESSIONAL CORPORATION  
ATTORNEYS AT LAW  
2525 EAST BROADWAY BOULEVARD, SUITE 200  
TUCSON, ARIZONA 85716-5300  
KAS/100805

RECEIVED  
BLM AZ STATE OFFICE  
2016 AUG -4 P 2:33  
PHOENIX, ARIZONA

PHOENIX  
AZ 852  
02 AUG '16  
PM 5 L

neopost<sup>®</sup>  
08/02/2016  
US POSTAGE

FIRST-CLASS MAIL

\$00.46<sup>5</sup>



ZIP 85716  
041L11236589

Bureau of Land Management  
Arizona State Office  
One North Central Ave.  
Phoenix, AZ 85004

85004-442700



**United States Department of the Interior**  
**Bureau of Land Management**  
 DIV OF LANDS, MINRLS & ENERGY  
 ONE N CENTRAL AVE  
 PHOENIX, AZ 85004 -4427  
 Phone: 602-417-9200

Receipt

No: 3621773

<b>Transaction #:</b> 3725522	
<b>Date of Transaction:</b> 08/05/2016	
CUSTOMER:	
DECONCINI MCDONALD YETWIN & LACY P C 2525 E BROADWAY BLVD STE 200 TUCSON, AZ 85716-5350 US	

LINE #	QTY	DESCRIPTION	REMARKS	UNIT PRICE	TOTAL
1	1.00	LOCATABLE MINERALS / MINING CLAIMS- NOT NEW-UNADJUD, ONE AUTH NO. ONLY / MINING CLAIM MONEY RECEIVED CASES: AMC429591/\$190.00	TRF - 19	- n/a -	190.00
<b>TOTAL:</b>					<b>\$190.00</b>

PAYMENT INFORMATION			
1	AMOUNT:	190.00	POSTMARKED: 08/02/2016
	TYPE:	CHECK	RECEIVED: 08/04/2016
	CHECK NO:	063046	
	NAME:	DECONCINI MCDONALD YETWIN & LACY PC 2525 E BROADWAY BLVD STE 200 TUCSON AZ 85716-5350 US	

REMARKS

This receipt was generated by the automated BLM Collections and Billing System and is a paper representation of a portion of the official electronic record contained therein.

*TRANSFER ONLY TO NOEL COUSINS. NEVER RECEIVED THE OTHER \$190 FOR STEVEN VAN ERT.  
 PO BOX IN CALIFORNIA IS NOT CORRECT. LR2000 SHOWS TUCSON, AZ FOR NOEL COUSINS. JB  
 30074*

**ENTERED**  
 OCT - 3 2016  
 BY: *[Signature]*



# USPS Tracking®

Still Have Questions?

[Browse our FAQs >](#)



Get Easy Tracking Updates >

Sign up for My USPS.

Tracking Number: 7015166000002718334

## Product & Tracking Information

Postal Product:

Features:  
Certified Mail™

DATE & TIME	STATUS OF ITEM	LOCATION
August 22, 2016 , 11:58 am	Delivered, Left with Individual	RENO, NV 89511
August 22, 2016 , 2:32 am	Departed USPS Facility	RENO, NV 89510
August 20, 2016 , 1:16 pm	Arrived at USPS Facility	RENO, NV 89510
August 19, 2016 , 7:38 am	Departed USPS Facility	PHOENIX, AZ 85026
August 18, 2016 , 7:19 pm	Arrived at USPS Facility	PHOENIX, AZ 85026

Your item was delivered to an individual at the address at 11:58 am on August 22, 2016 in RENO, NV 89511.

## Available Actions

[Text Updates](#)

[Email Updates](#)

## Track Another Package

Tracking (or receipt) number

[Track It](#)

## Manage Incoming Packages

Track all your packages from a dashboard. No tracking numbers necessary.



[Sign up for My USPS >](#)

### HELPFUL LINKS

- [Contact Us](#)
- [Site Index](#)
- [FAQs](#)

### ON ABOUT.USPS.COM

- [About USPS Home](#)
- [Newsroom](#)
- [USPS Service Updates](#)
- [Forms & Publications](#)
- [Government Services](#)
- [Careers](#)

### OTHER USPS SITES

- [Business Customer Gateway](#)
- [Postal Inspectors](#)
- [Inspector General](#)
- [Postal Explorer](#)
- [National Postal Museum](#)
- [Resources for Developers](#)

### LEGAL INFORMATION

- [Privacy Policy](#)
- [Terms of Use](#)
- [FOIA](#)
- [No FEAR Act EEO Data](#)

**NOTICE!!**

**These documents have been scanned!**

**Do not place un-scanned documents beneath this notice!**

**Do not remove this notice from this file!**

GPO Jacket No. 560-102  
Print Order 61540  
Rise Business Services, LLC  
Job=AZ15 5/10/2019



Box Number= AZ15030



Claim Begin-End: AMC430297-AMC430300

4 Annual Filings



AZ15030-31

AMC429998-AMC430297



UNITED STATES  
DEPARTMENT OF THE INTERIOR  
BUREAU OF LAND MANAGEMENT  
**MAINTENANCE FEE PAYMENT FORM FOR  
LODE CLAIMS, MILL SITES, AND TUNNEL SITES**

AMC 429591  
430297

Remitter Name: Noel Cousins  
Mailing Address: P.O. Box 37061  
City, State, Zip: Tucson, AZ 85740

Check here if this is a change of address.

**FOR COUNTY RECORDER'S USE**

No. of claims/sites 11  
x \$155 per claim/site  
Total due BLM \$ 1705

- The maintenance fee may be paid by cash, check, money order, Bureau of Land Management (BLM) Declining Deposit Account, or credit card (VISA, American Express, Discover, or MasterCard). Payments must be remitted to the BLM State Office where your claim or site is recorded and received on or before September 1. If the payment is mailed, the envelope must be postmarked by a bona fide delivery service on or before September 1 and received at the proper BLM State Office within 15 calendar days after the due date. Payments may also be made by telephone using a credit card. A complete listing of BLM State Offices with their addresses and phone numbers can be found at <http://www.blm.gov>.
- The maintenance fee for the following claim(s)/site(s) applies to the assessment year 2019.

CLAIM/SITE NAME	BLM SERIAL NO.
ARDMORE #101	AMC 429591
ARDMORE #102	AMC 429592
ARDMORE #103	AMC 429593
ARDMORE #104	AMC 429594
ARDMORE #107	AMC 429597
ARDMORE #110	AMC 429600
ARDMORE #111	AMC 430297
ARDMORE #112	AMC 430298
ARDMORE #113	AMC #430299
ARDMORE #132	AMC 429602

Use a separate sheet for additional claim/site names, serial numbers, and claimant names and addresses.

(Continued on page 2)

**ENTERED**  
AUG 30 2018  
BY: [Signature]

# 4247727

**MAINTENANCE FEE PAYMENT FORM FOR  
ARDMORE LODE CLAIMS  
PAGE 1 CONTINUED**

Remitter Name: Noel Cousins  
Mailing Address: P. O. Box 37061  
City, State, Zip: Tucson, AZ 85740

**CLAIM NAME**

**BLM SERIAL NO.**

**ARDMORE #133**

**AMC 429603**

PHOENIX, ARIZONA

2018 AUG 27 P 2:38

RECEIVED  
BLM AZ STATE OFFICE

Bureau of Land Management  
Arizona State Office  
One North Central Avenue, Suite 800  
Phoenix AZ 85004-4427

ATTN: Mining Claims

August 24, 2018

BLM: Enclosed with this letter please find a Maintenance Fee Payment Form and my check in the amount of \$1705.00 for the 11 claims in Pinal Co. Arizona described on the form for the assessment year ending Sept. 1, 2019.



Noel Cousins

RECEIVED  
BLM AZ STATE OFFICE  
2018 AUG 27 P 2:38  
PHOENIX, ARIZONA

Moe Cousins  
PO Box 37061  
Tucson, AZ 85740



NEOPOST  
08/24/2018  
US POSTAGE \$006.70<sup>00</sup>

RECEIVED  
BLM  
2018 AUG 27 P 2:31  
PHOENIX, ARIZONA

Bureau of Land Management  
Arizona State Office  
One North Central Ave, Suite 800  
Phoenix AZ 85004-4427  
ATTN: Mining Claims

ZIP 85739  
041M10265915

85004-442700

08/24/2018

**United States Department of the Interior**  
**Bureau of Land Management**  
 DIV OF LANDS, MINRLS & ENERGY  
 ONE N CENTRAL AVE  
 PHOENIX, AZ 85004 -4427  
 Phone: 602-417-9200

Receipt

No: 4247727

<b>Transaction #:</b> 4363201	
<b>Date of Transaction:</b> 08/28/2018	
<b>CUSTOMER:</b>	
NOEL COUSINS PO BOX 37061 TUCSON, AZ 85740-7061 US	

LINE #	QTY	DESCRIPTION	REMARKS	UNIT PRICE	TOTAL
1	1.00	LOCATABLE MINERALS / MINING CLAIMS- NOT NEW-UNADJUD, ONE AUTH NO. ONLY / MINING CLAIM MONEY RECEIVED <b>CASES: AMC429591/\$1705.00</b>	MAINT 2019/11	- n/a -	1705.00
<b>TOTAL:</b>					<b>\$1,705.00</b>

PAYMENT INFORMATION			
1	AMOUNT:	1705.00	POSTMARKED: N/A
	TYPE:	CHECK	RECEIVED: 08/27/2018
	CHECK NO:	8129	
	NAME:	COUSINS, NOEL PO BOX 37061 TUCSON AZ 85740-7061 US	

REMARKS

This receipt was generated by the automated BLM Collections and Billing System and is a paper representation of a portion of the official electronic record contained therein.

AMC 429591  
430297

UNITED STATES  
DEPARTMENT OF THE INTERIOR  
BUREAU OF LAND MANAGEMENT  
**MAINTENANCE FEE PAYMENT FORM FOR  
LODE CLAIMS, MILL SITES, AND TUNNEL SITES**

Remitter Name: Noel Cousins  
Mailing Address: PO Box 37061  
City, State, Zip: Tucson, AZ 85740

Check here if this is a change of address.

**FOR COUNTY RECORDER'S USE**

No. of claims/sites 11  
x \$155 per claim/site  
Total due BLM \$ 1705

- The maintenance fee may be paid by cash, check, money order, Bureau of Land Management (BLM) Declining Deposit Account, or credit card (VISA, American Express, Discover, or MasterCard). Payments must be remitted to the BLM State Office where your claim or site is recorded and received on or before September 1. If the payment is mailed, the envelope must be postmarked by a bona fide delivery service on or before September 1 and received at the proper BLM State Office within 15 calendar days after the due date. Payments may also be made by telephone using a credit card. A complete listing of BLM State Offices with their addresses and phone numbers can be found at <http://www.blm.gov>.
- The maintenance fee for the following claim(s)/site(s) applies to the assessment year 2018.

CLAIM/SITE NAME	BLM SERIAL NO.
ARDMORE #101	AMC 429591
ARDMORE #102	AMC 429592
ARDMORE #103	AMC 429593
ARDMORE #104	AMC 429594
ARDMORE #107	AMC 429597
ARDMORE #110	AMC 429600
ARDMORE #111	AMC 430297
ARDMORE #112	AMC 430298
ARDMORE #113	AMC 430299
ARDMORE #132	AMC 429602

Use a separate sheet for additional claim/site names, serial numbers, and claimant names and addresses.

(Continued on page 2)

**ENTERED**  
AUG 22 2017  
BY: [Signature]

# 39266916



**MAINTENANCE FEE PAYMENT FORM FOR  
ARDMORE LODE CLAIMS**

**PAGE 2**

Remitter Name: Noel Cousins  
Mailing Address: P.O. Box 37061  
City, State, Zip: Tucson, AZ 85740

**CLAIM NAME**

**BLM SERIAL NO.**

**ARDMORE #133**

**AMC 429603**

2017 AUG -7 P 3:06

**NOEL COUSINS**

P.O. Box 37061 ~ Tucson, Arizona 85740  
Phone (520) 498 9958 ~ Fax (520) 498 9959

Bureau of Land Management  
Arizona State Office  
One North Central Ave, Suite 800  
Phoenix, AZ 85004-4427

ATTN: Mining Claims

August 4, 2017

BLM: Enclosed with this letter please find a Maintenance Fee Payment Form and my check in the amount of \$1705.00 for the 11 claims in Pinal County, AZ described on the form for the assessment year ending Sept. 1, 2018.

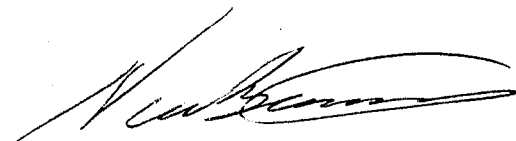

Noel Cousins

PHOENIX, ARIZONA

2017 AUG -7 P 3:06

**United States Department of the Interior**  
**Bureau of Land Management**  
 DIV OF LANDS, MINRLS & ENERGY  
 ONE N CENTRAL AVE  
 PHOENIX, AZ 85004 -4427  
 Phone: 602-417-9200

Receipt

No: 3926696

<b>Transaction #:</b> 4036240	
<b>Date of Transaction:</b> 08/08/2017	
<b>CUSTOMER:</b>	
NOEL COUSINS PO BOX 37061 TUCSON,AZ 85740-7061 US	

LINE #	QTY	DESCRIPTION	REMARKS	UNIT PRICE	TOTAL
1	1.00	LOCATABLE MINERALS / MINING CLAIMS- NOT NEW-UNADJUD,ONE AUTH NO. ONLY / MINING CLAIM MONEY RECEIVED CASES: AMC429591/\$1705.00		- n/a -	1705.00
<b>TOTAL:</b>					<b>\$1,705.00</b>

PAYMENT INFORMATION					
1	AMOUNT:	1705.00	POSTMARKED:	08/04/2017	
	TYPE:	CHECK	RECEIVED:	08/07/2017	
	CHECK NO:	7913			
	NAME:	COUSINS, NOEL PO BOX 37061 TUCSON AZ 85740-7061 US			

REMARKS

This receipt was generated by the automated BLM Collections and Billing System and is a paper representation of a portion of the official electronic record contained therein.

429591

430297

**MAINTENANCE FEE PAYMENT**

Claimant Name: Evrkim Resources USA Inc

Address: PO Box 37061

City: TUCSON State: AZ Zip: 85740

Telephone: (520) 498-9958

E-mail address: geoex@hotmail.com

Signature: [Handwritten Signature]

Check here if this is a change of address.

*UPDATION  
9/6/16 RAM*

RECEIVED  
BLM AZ STATE OFFICE  
2016 SEP - 1 P 3:02  
PHOENIX, ARIZONA

BLM  
Date  
Stamp

LINE NO.	AMC NUMBER	CLAIM/SITE NAME	COUNTY RECORDER DATA (If available)	TWP	RNG	SEC
1	429591	ARDMORE#101	2014-071788	8S	14E	9
2	429592	ARDMORE#102	2014-071789	8S	14E	9
3	429593	ARDMORE#103	2014-071790	8S	14E	9
4	429594	ARDMORE#104	2014-071791	8S	14E	9
5	429597	ARDMORE#107	2014-071794	8S	14E	9
6	429600	ARDMORE#110	2014-071797	8S	14E	9
7	430297	ARDMORE#111	2015-005476	8S	14E	15
8	430298	ARDMORE#112	2015-005477	8S	14E	15
9	430299	ARDMORE#113	2015-005478	8S	14E	15
10	429602	ARDMORE#132	2014-071799	8S	14E	16

List additional claims on Form MCF114.

Bureau of Land Management  
Arizona State Office  
[www.blm.gov/az/](http://www.blm.gov/az/)

No. of Claims\*: 11 x \$155 = \$1705.00

Check No.: 7231 Init. AS

Receipt No.: 3650767

For BLM Use Only

\* \$155 per lode mining claim, mill site, or tunnel site; and \$155 for each 20 acres or portion thereof for each placer mining claim.

Form: MCF112  
Revised July 2014

This form is available from the Arizona Geological Survey and may be reproduced.

SEP 06 2016  
RAM



**SUPPLEMENTAL ATTACHMENT**

May be used with the following forms for listing additional mining claims:

Check One.

- Affidavit of Performance of Annual Work
- Maintenance Fee Payment
- Notice of Intent to Hold Mining Claims
- Notice of Non-Liability for Labor and Materials Furnished
- Quit claim Deed

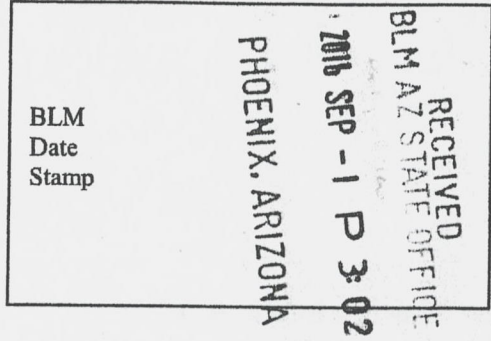

LINE NO.	AMC NUMBER	CLAIM/SITE NAME	COUNTY RECORDER DATA (If available)	TWP	RNG	SEC
11	429603	ARDMORE #133	2014-071800	8S	14E	16

## MINING CLAIMS

MC Customer Information - With Serial No. and Claim Name  
ACTIVE CLAIMS

Admin State: AZ

Geo State: AZ

EVRIM RESOURCES USA INC  
6121 LAKESIDE DR STE 260  
RENO, NV 89511-8534

CUSTOMER ID: 2370687

<u>Serial No.</u>	<u>Claim Name/Number</u>	<u>Lead Serial No.</u>	<u>Disposition</u>
AMC429591 ✓	ARDMORE #101	AMC429591	ACTIVE
AMC429592 ✓	ARDMORE #102	AMC429591	ACTIVE
AMC429593 ✓	ARDMORE #103	AMC429591	ACTIVE
AMC429594 ✓	ARDMORE #104	AMC429591	ACTIVE
✓ <del>AMC429595</del>	ARDMORE #105	AMC429591	ACTIVE
✓ <del>AMC429596</del>	ARDMORE #106	AMC429591	ACTIVE
AMC429597 ✓	ARDMORE #107	AMC429591	ACTIVE
AMC429598	ARDMORE #108	AMC429591	ACTIVE
<del>AMC429599</del>	ARDMORE #109	AMC429591	ACTIVE
AMC429600 ✓	ARDMORE #110	AMC429591	ACTIVE
AMC429601 ✓	ARDMORE #131	AMC429591	ACTIVE
AMC429602 ✓	ARDMORE #132	AMC429591	ACTIVE
AMC429603 ✓	ARDMORE #133	AMC429591	ACTIVE
AMC429604	ARDMORE #134	AMC429591	ACTIVE
AMC429605	ARDMORE #135	AMC429591	ACTIVE
AMC430297 ✓	ARDMORE # 111	AMC430297	ACTIVE
AMC430298 ✓	ARDMORE # 112	AMC430297	ACTIVE
AMC430299 ✓	ARDMORE # 113	AMC430297	ACTIVE
AMC430300	ARDMORE # 114	AMC430297	ACTIVE

Number of ACTIVE cases: 19

PO Box 37061  
Tucson, AZ  
85740

**CERTIFIED MAIL**



PHOENIX  
AZ 852  
28 AUG 16  
PM 6 L 1000



85004

U.S. POSTAGE  
PAID  
TUCSON, AZ  
85726  
AUG 28, 16  
AMOUNT  
**\$3.77**  
R2304E106644-01

7016 0910 0000 1158 7550

Bureau of Land Management  
1 N Central Ave Ste 800  
Phoenix, AZ 85004

RECEIVED  
BLM AZ STATE OFFICE

2016 SEP -1 P 3:02

PHOENIX, ARIZONA

85004-442700

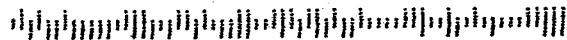

**United States Department of the Interior**  
**Bureau of Land Management**  
 DIV OF LANDS, MINRLS & ENERGY  
 ONE N CENTRAL AVE  
 PHOENIX, AZ 85004 -4427  
 Phone: 602-417-9200

Receipt

No: 3650767

<b>Transaction #:</b> 3754792	
<b>Date of Transaction:</b> 09/02/2016	
<b>CUSTOMER:</b>	
EVRIM RESOURCES USA INC PO BOX 37061 TUCSON, AZ 85740-7061 US	

LINE #	QTY	DESCRIPTION	REMARKS	UNIT PRICE	TOTAL
1	1.00	LOCATABLE MINERALS / MINING CLAIMS- NOT NEW-UNADJUD, ONE AUTH NO. ONLY / MINING CLAIM MONEY RECEIVED <b>CASES: AMC429591/\$1705.00</b>	MAINT FEE 2017 - 11	- n/a -	1705.00
<b>TOTAL:</b>					<b>\$1,705.00</b>

PAYMENT INFORMATION			
1	AMOUNT:	1705.00	POSTMARKED: 08/29/2016
	TYPE:	CHECK	RECEIVED: 09/01/2016
	CHECK NO:	7731	
	NAME:	COUSINS, NOEL PO BOX 37061 TUCSON AZ 85740-7061 US	

REMARKS

This receipt was generated by the automated BLM Collections and Billing System and is a paper representation of a portion of the official electronic record contained therein.



HARRIS, THOMPSON & FAILLERS  
AN ASSOCIATION OF ATTORNEYS

RICHARD W. HARRIS  
RICHARD K. THOMPSON (1951-2013)  
JEFF N. FAILLERS

6121 LAKESIDE DRIVE  
SUITE 260  
RENO, NEVADA 89511  
PHONE (775) 825-4300  
FAX (775) 825-4829

429591  
430297

August 25, 2015

BY FEDERAL EXPRESS

Mining Records Division  
Arizona State Office  
Bureau of Land Management  
One North Central Avenue, Suite 800  
Phoenix, Arizona 85004

Re: 2015-2016 Federal Claim Maintenance Fees (Ardmore Claim Group)

Dear Sir or Madam:

I enclose our Trust Check No. 6192 in the amount of \$2,945.00. This represents payment of the 2015-2016 federal claim maintenance fees for "Ardmore" group of unpatented lode mining claims situated in Pinal County, Arizona (19 claims at \$155.00 per claim). The claims are more particularly described on Exhibit A attached hereto.

The foregoing claim maintenance fees have been paid by the claim owner, Evrim Resources Corp., whose address is 910 - 850 West Hastings Street, Vancouver, British Columbia, Canada V6C 1E1.

Please return evidence of filing to this office. Thank you for your attention.

Very truly yours,

*Richard W. Harris*

Richard W. Harris

RECEIVED  
BLM AZ STATE OFFICE  
2015 AUG 26 A 9:41  
PHOENIX, ARIZONA

RWH/cab  
(w) 2015 Mining/Evrim Resources/9016  
check/exhibit A  
cc: Mr. Stewart Harris (by e-mail)

RECEIPT # 3378378

**EXHIBIT A**  
Pinal County, Arizona

<u>Claim Name</u>	<u>BLM Serial Number</u>
ARDMORE #101	AMC429591
ARDMORE #102	AMC429592
ARDMORE #103	AMC429593
ARDMORE #104	AMC429594
ARDMORE #105	AMC429595
ARDMORE #106	AMC429596
ARDMORE #107	AMC429597
ARDMORE #108	AMC429598
ARDMORE #109	AMC429599
ARDMORE #110	AMC429600
ARDMORE #131	AMC429601
ARDMORE #132	AMC429602
ARDMORE #133	AMC429603
ARDMORE #134	AMC429604
ARDMORE #135	AMC429605
ARDMORE # 111	AMC430297
ARDMORE # 112	AMC430298
ARDMORE # 113	AMC430299
ARDMORE # 114	AMC430300

TOTAL: 19 claims

(w) 2015 Mining/Evrim Resources/9016

RECEIVED  
BLM AZ STATE OFFICE  
2015 AUG 26 A 9:41  
PHOENIX, ARIZONA

# FedEx®

## Express

ORIGIN ID:RNOA (775) 825-4300  
RICHARD HARRIS  
HARRIS & THOMPSON  
6121 LAKESIDE DRIVE, SUITE 280

SHIP DATE: 25AUG15  
ACTWGT: 0.20 LB  
CAD: 3480811/NET3870

RENO, NV 89511  
UNITED STATES US

BILL SENDER

TO ARIZONA STATE OFFICE  
BUREAU OF LAND MANAGEMENT  
1 N CENTRAL AVE  
STE 800  
PHOENIX AZ 85004

633JIFECAG100

(000) 000-0000 REF: 9016  
INV: DEPT:

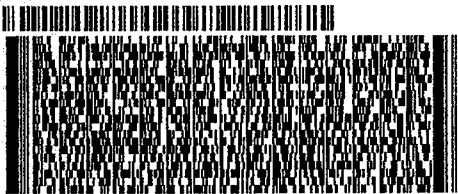

FedEx Ship Manager - Print Your Label(s)

WED - 26 AUG 10:30A  
PRIORITY OVERNIGHT

TRK# 7743 6452 9209  
0201

WP ZSYA

85004  
AZ-US PHX

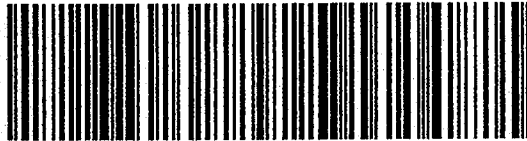

Extremely Urgent

8/25/2015

← Inse doc: RT 275 2 10:30 D 9209 08.26  
ST 4

**FedEx**  
Express

**earth**smart  
FedEx carbon-neutral  
envelope shipping

Align top of FedEx Express® shipping label here.

Envelope

RECEIVED  
BLM AZ STATE OFFICE  
2015 AUG 26 A 9 41  
PHOENIX, ARIZONA



**United States Department of the Interior**  
**Bureau of Land Management**  
LANDS/RECREATION & PLANNING  
ONE N CENTRAL AVE  
PHOENIX, AZ 85004 -2203  
Phone: 602-417-9200

Receipt

No: 3378378

<b>Transaction #:</b> 3476633	
<b>Date of Transaction:</b> 08/27/2015	
CUSTOMER:	
RICHARD W HARRIS 6121 LAKESIDE DR STE 260 RENO, NV 89511-8534 US	

LINE #	QTY	DESCRIPTION	REMARKS	UNIT PRICE	TOTAL
1	1.00	LOCATABLE MINERALS / MINING CLAIMS-NOT NEW-UNADJUD, ONE AUTH NO. ONLY / MINING CLAIM MONEY RECEIVED CASES: AMC429591/\$2945.00	MAINT FEE PYMNT - 19 2016	- n/a -	2945.00
<b>TOTAL:</b>					<b>\$2,945.00</b>

PAYMENT INFORMATION			
1	AMOUNT:	2945.00	POSTMARKED: 08/26/2015
	TYPE:	CHECK	RECEIVED: 08/26/2015
	CHECK NO:	6192	
	NAME:	HARRIS, RICHARD W 6121 LAKESIDE DR STE 260 RENO NV 89511-8534 US	

REMARKS

This receipt was generated by the automated BLM Collections and Billing System and is a paper representation of a portion of the official electronic record contained therein.

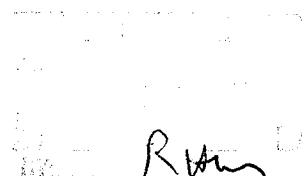

8/27/2015

**NOTICE!!**

**These documents have been scanned!**

**Do not place un-scanned documents beneath this notice!**

**Do not remove this notice from this file!**

GPO Jacket No. 560-102  
Print Order 61540  
Rise Business Services, LLC  
Job=AZ15 5/10/2019



Box Number= AZ15030



Claim Begin-End: AMC430297-AMC430300

5 Miscellaneous



AZ15030-31

AMC429998-AMC430297

# LOCATION SURVEY - CLAIM MAP

EVRIM RESOURCES USA INC.  
ARDMORE LODE MINING CLAIMS  
PORTIONS OF SECTIONS 9, 15 AND 16, TOWNSHIP 8 SOUTH  
RANGE 14 EAST, GILA AND SALT RIVER MERIDIAN,  
PINAL COUNTY, ARIZONA.

OCTOBER 11 THRU 14, 2014  
DECEMBER 10, 2014

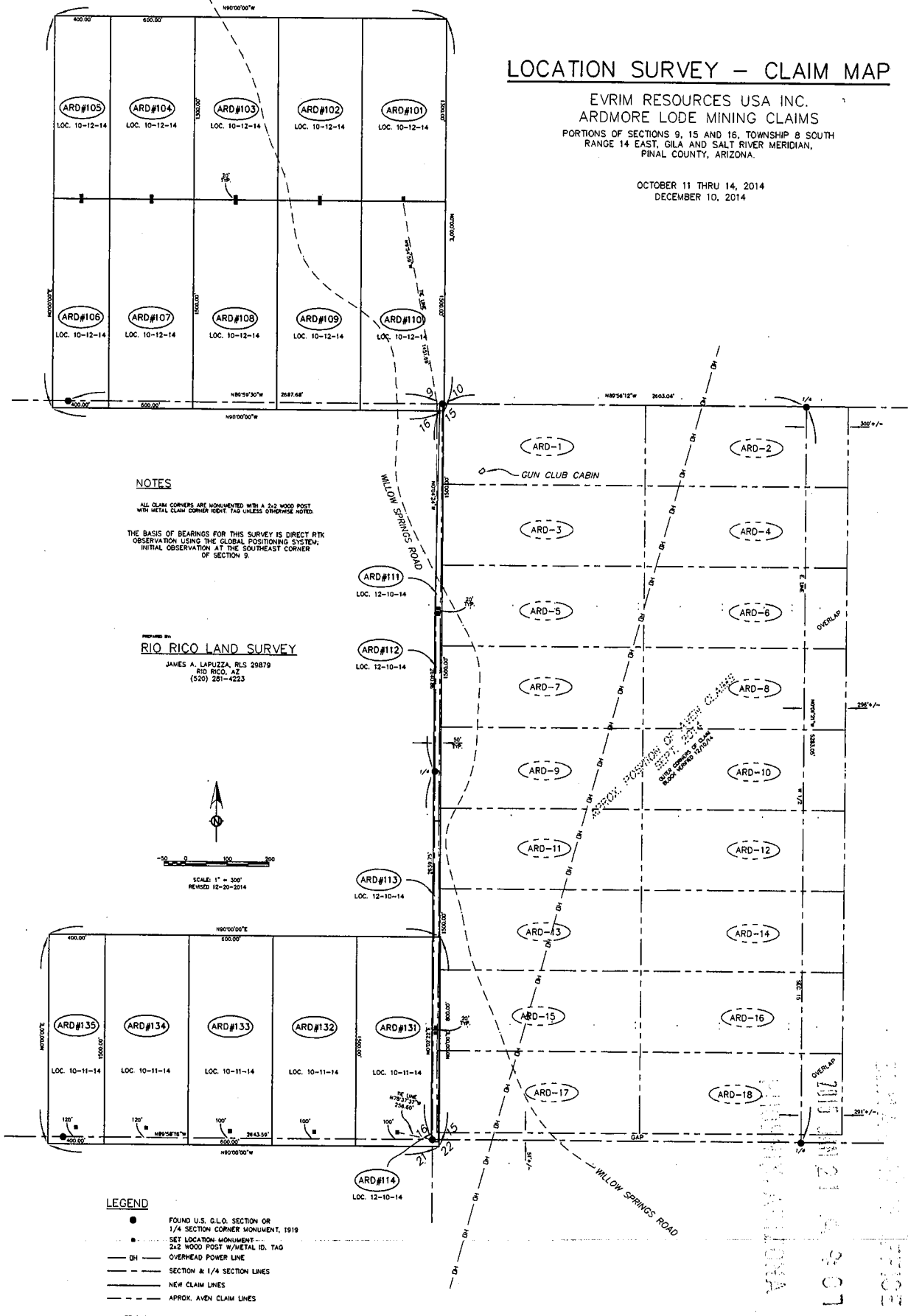

### NOTES

ALL CLAIM CORNERS ARE MONUMENTED WITH A 2x2 WOOD POST WITH METAL CLAIM CORNER IDENT. TAG UNLESS OTHERWISE NOTED.

THE BASIS OF BEARINGS FOR THIS SURVEY IS DIRECT RTK OBSERVATION USING THE GLOBAL POSITIONING SYSTEM; INITIAL OBSERVATION AT THE SOUTHEAST CORNER OF SECTION 9.

PREPARED BY:  
**RIQ RICO LAND SURVEY**  
JAMES A. LAPIZZA, RLS 29879  
RIQ RICO, AZ  
(520) 281-4223

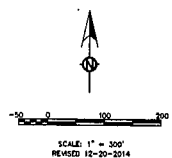

### LEGEND

- FOUND U.S. G.L.O. SECTION OR 1/4 SECTION CORNER MONUMENT, 1919
- SET LOCATION MONUMENT - 2x2 WOOD POST W/METAL ID. TAG
- OVERHEAD POWER LINE
- SECTION & 1/4 SECTION LINES
- NEW CLAIM LINES
- - - - - APPROX. AVEN CLAIM LINES

SET 2x2 WOOD POST WITH METAL ID. TAGS AT ALL CLAIM CORNERS AND END CENTERS

AMC430297



# Almar Professional Land Services, Inc.

Corporate Office: 450 Hillside Drive, Suite A-160 • Mesquite, NV 89027  
Toll Free (877) 868-6611 • Toll Free Fax (866) 221-2671 • Website: [www.almarpls.com](http://www.almarpls.com)  
Midwestern Office: Baraboo, WI • Southeastern Office: Navarre, FL

**Marty Miller**  
Certified Professional Landman (CPL)  
Certified Environmental Inspector (CEI)  
E-mail: [marty@almarpls.com](mailto:marty@almarpls.com)  
Cell (970) 260-2214

January 20, 2015

Bureau of Land Management  
One North Central Avenue, Suite 800  
Phoenix, AZ 85004-4427

VIA OVERNIGHT FEDERAL EXPRESS

RE.: Filing 4 New Unpatented Lode Mining Claims (2 pages each)  
Ardmore #111 through Ardmore #114, inclusive  
Pinal County, Arizona

To whom it may concern:

Enclosed you should find 4 original "Location Notices for Lode Mining Claims" for claims named Ardmore #111 through Ardmore #114, inclusive each, consists of 2 pages. Also enclosed you should find our check number 1544, in the amount of \$848.00; for the \$20 per claim processing fee, the location fee of \$37 per claim, and the 2014-2015 Maintenance fee of \$155 per claim, which represents \$212 per claim:

1. Ardmore #111
2. Ardmore #112
3. Ardmore #113
4. Ardmore #114

We also have enclosed the claim map, indicating the location of the claims as located.

Once these 4 Location Notices have been stamped with the AMC numbers, please forward our enclosed copies to our office **8668 Navarre Pkwy, Suite 113, Navarre, FL 32566, using the enclosed postage prepaid self-addressed envelope.**

Please **return** originals to our Florida Office, at **8668 Navarre Pkwy, Suite 113, Navarre, FL 32566.**

Sincerely,

ALMAR PROFESSIONAL LAND SERVICES, INC.

Marty Miller  
Certified Professional Landman #3759  
Certified Environmental Inspector

Attach.: 4 Location Notices & Check #1544

AMC430297

RECEIVED  
BLM AZ STATE OFFICE  
2015 JAN 21 A 9:05  
PHOENIX, ARIZONA

**NOTICE!!**

**These documents have been scanned!**

**Do not place un-scanned documents beneath this notice!**

**Do not remove this notice from this file!**

GPO Jacket No. 560-102  
Print Order 61540  
Rise Business Services, LLC  
Job=AZ15 5/10/2019



Box Number= AZ15030



Claim Begin-End: AMC430297-AMC430300

6 Location Notices-Amendments and Supporting Documents



AZ15030-31

AMC429998-AMC430297



# MINING CLAIM STATUS REPORT

Data Entered: 02/17/15 RAm

MTP Checked By: 02/17/15 RAm

GEO Checked By: 02/17/15 RAm

LEAD SERIAL NUMBER: AMC 430297 thru AMC 430300

**NUMBER OF CLAIMS & TYPE:**

4 LODE  
\_\_\_\_ PLACER  
\_\_\_\_ ASSOCIATION PLACER  
\_\_\_\_ MILL SITE  
\_\_\_\_ TUNNEL SITE

**CHARGES:**

Location Fee @ \$37 = \$ 148.00  
Processing Fee @ \$20 = \$ 80.00  
Maintenance Fee @ \$155 = \$ 620.00  
Add'l Maint Fee for Assoc Placer = \$ \_\_\_\_\_  
**SUBTOTAL** \$ 848.00  
Other Fees \$ \_\_\_\_\_  
Other Fees \$ \_\_\_\_\_  
**TOTAL** \$ 848.00

TOTAL ACREAGE: N/A Per Claim  
(Placer Only)

NUMBER OF LOCATORS: 1

DOCUMENTS RECEIVED VIA : Over-the-Counter [ ] Mail [  ] **TIMELY FILED:** Yes [  ] No [ ]

LEGAL DESCRIPTION: T 85 R 14E SEC 15  
T \_\_\_\_\_ R \_\_\_\_\_ SEC \_\_\_\_\_  
T \_\_\_\_\_ R \_\_\_\_\_ SEC \_\_\_\_\_  
T \_\_\_\_\_ R \_\_\_\_\_ SEC \_\_\_\_\_  
T \_\_\_\_\_ R \_\_\_\_\_ SEC \_\_\_\_\_

BLM [ ] FOREST SERVICE [ ] SUBJ TO PL 359: Yes [ ] No [ ]  
WILDERNESS AREA [ ] \_\_\_\_\_

SPLIT ESTATE: N/A [ ] SX [ ] PX [ ] OTHER [ ]  
SRHA [ ] Was proper Notice filed if located on SHRA Land? Yes [ ] No [ ]

**RECONVEYED MINERALS ON BLM LAND REQUIRE OPENING ORDER FROM 1944 TO 1993:**

Open to Entry On \_\_\_\_\_ N/A [ ]

COMMENTS/STATUS: VOID [ ] PARTIALLY VOID [ ] PVT MINERALS [ ] WITHDRAWN LANDS [ ]  
OTHER [ ] \_\_\_\_\_

*(Small)*  
Portions of AMCH30297-299 are on lands which the Fed govt does not own or manage the surface or mineral estate & therefore extends no rights to mine on those lands

MZB tie-ins & bearings seem a tiny amount off but acceptable  
[ ] Claimant acknowledges that portions of the following claim(s) site(s) may be void or voidable.

Printed Name of Claimant \_\_\_\_\_ Signature of Claimant \_\_\_\_\_

\*\*\*\*\*FINAL ADJUDICATION\*\*\*\*\*

DATE 4-14-15 INITIALS RS

AMC430297

LOCATION NOTICE FOR LODE MINING CLAIM

NOTICE IS HEREBY GIVEN that the ARMORE # 111  
\_\_\_\_\_ lode mining claim has been located  
by EVRIIM RESOURCES USA INC.,  
A NV CORPORATION whose current mailing  
address is 6121 LAKESIDE DRIVE, SUITE 200  
RENO, NV 89511

RECEIVED  
BLM AZ STATE OFFICE  
2015 JAN 21 A 9:05  
PHOENIX, ARIZONA  
BLM  
Date  
Stamp

The general course of this claim is NORTH-SOUTH and it is situated in PINAL  
County, Arizona. This claim is 1500 feet in length and 50 feet in width. This claim runs  
from the location monument on which this location notice is posted approximately 1480 feet in a  
NORTH direction to the NORTH end line and 20 feet in a SOUTH direction to the  
SOUTH end line. This claim is marked by six monuments, one at each corner and one at the center of each  
end line of the claim.

The location monument on which this notice is posted is situated within Section 15, Township 8  
S., Range 14 E., Gila Salt River Base and Meridian, Arizona and this claim encompasses portions  
of the following quarter section (s), section (s), Township (s) and Range (s) NW 1/4 SEC. 15  
T. 8 S. R. 14 E. 6 & SRM.

Gila Salt River Base and Meridian, Arizona.

The locality of this claim with reference to some natural object or permanent monument and additional information  
(if any) concerning its locality are as follows: THE LOCATION MONUMENT BEARS 5.0°46'37"E,  
1475.14 FT. DISTANT FROM THE NW CORNER OF SECTION 15,  
T. 8 S. R. 14 E. 6 & SRM.

DATED AND POSTED on the ground this 10TH day of DECEMBER, 20 14.

LOCATOR (s) [Signature]  
JAMES A. LAPUZZA, MS, RLS  
FOR EVRIIM RESOURCES USA INC.

Form MCF100  
Revised July 2005

AM04302971

**MINING CLAIM MAP**

Lode (X) Placer ( )

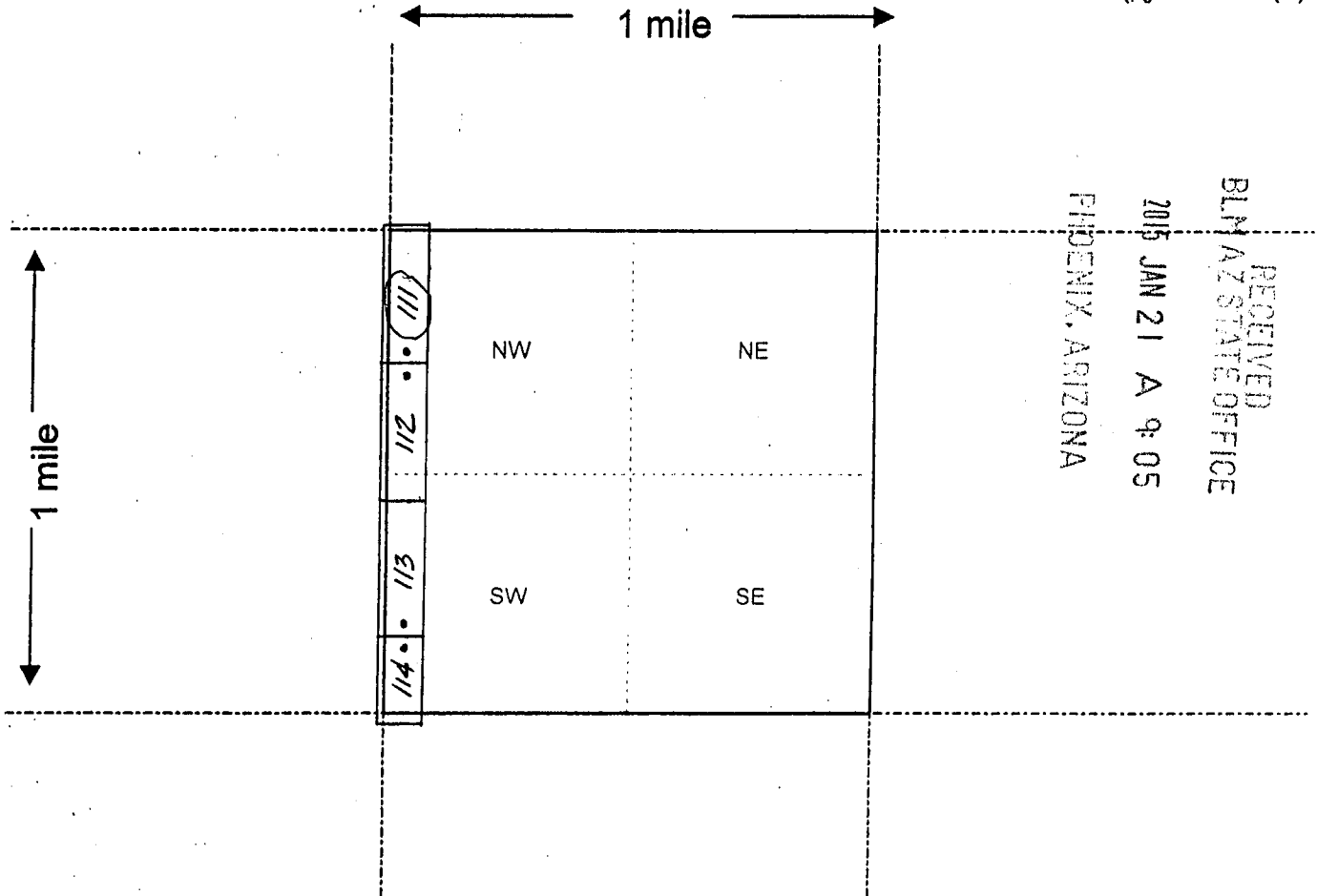

RECEIVED  
BLM AZ STATE OFFICE  
2015 JAN 21 A 9:05  
PHOENIX, ARIZONA

AMC430297

Scale: 1" = 2000 feet



1. The above map depicts the ARMORE # 111 mining claim, which is located in Section (8)  
15, Township 8 S., Range 14 E., Gila and Salt River Base and Meridian,  
PINAL County, Arizona.

2. The type of corner and location monuments used are as follows: 2" x 2" WOOD POST  
WITH METAL IDENTIFICATION TAG

3. The bearings and distances in degrees and feet between claim corners are as depicted on the map.  
(SEE PG. 1)

Form MCF100a  
Revised July 2005

This form is available from the Arizona Department of Mines & Mineral Resources and may be reproduced.

LOCATION NOTICE FOR LODE MINING CLAIM

NOTICE IS HEREBY GIVEN that the ARMORE # 112  
\_\_\_\_\_ lode mining claim has been located  
by EVERIM RESOURCES USA INC.,  
A NV CORPORATION whose current mailing  
address is 6121 LAKESIDE DRIVE, SUITE 200  
RENO, NV 89511

RECEIVED  
BLM AZ STATE OFFICE  
2015 JAN 21 A 9:06  
PHOENIX, ARIZONA  
BLM  
Date  
Stamp

The general course of this claim is NORTH-SOUTH and it is situated in PINAL  
County, Arizona. This claim is 1500 feet in length and 50 feet in width. This claim runs  
from the location monument on which this location notice is posted approximately 20 feet in a  
NORTH direction to the NORTH end line and 1480 feet in a SOUTH direction to the  
SOUTH end line. This claim is marked by six monuments, one at each corner and one at the center of each  
end line of the claim.

The location monument on which this notice is posted is situated within Section 15, Township 8  
S., Range 14 E., Gila Salt River Base and Meridian, Arizona and this claim encompasses portions  
of the following quarter section (s), section (s), Township (s) and Range (s) NW 1/4 & SW 1/4  
T. 8 S. R. 14 E. 6 & SRM.

Gila Salt River Base and Meridian, Arizona.  
The locality of this claim with reference to some natural object or permanent monument and additional information  
(if any) concerning its locality are as follows: THE LOCATION MONUMENT BEARS 50°45'23"E,  
1515.13 FT. DISTANT FROM THE NW CORNER OF SECTION 15,  
T. 8 S. R. 14 E. 6 & SRM.

DATED AND POSTED on the ground this 10<sup>TH</sup> day of DECEMBER, 20 14.

LOCATOR (s) [Signature]  
JAMES A. LAPUZZA, MS, RLS  
FOR EVERIM RESOURCES USA INC.

Form MCF100  
Revised July 2005

AMC430298

**MINING CLAIM MAP**

Lode (X) Placer ( )

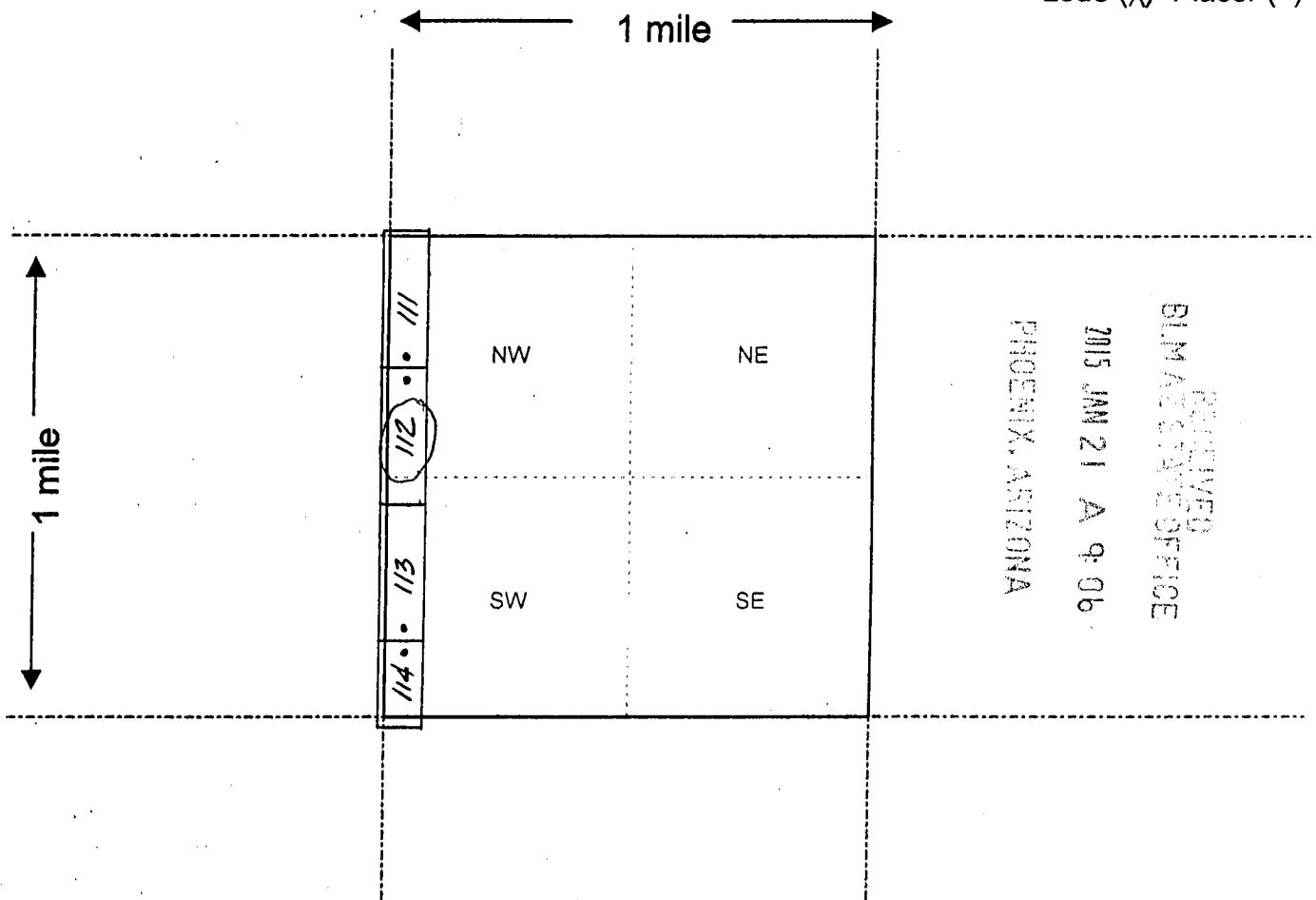

RECEIVED  
BLM AZ & SWE OFFICE  
2015 JAN 21 A 9:06  
PHOENIX, ARIZONA

Scale : 1" = 2000 feet



1. The above map depicts the ARMORE # 112 mining claim, which is located in Section (s) 15, Township 8 S., Range 14 E., Gila and Salt River Base and Meridian, PINAL County, Arizona.

2. The type of corner and location monuments used are as follows: 2" x 2" WOOD POST WITH METAL IDENTIFICATION TAG

3. The bearings and distances in degrees and feet between claim corners are as depicted on the map.  
(SEE PG. 1)

Form MCF100a  
Revised July 2005

This form is available from the Arizona Department of Mines & Mineral Resources and may be reproduced.

AMC 430298



LOCATION NOTICE FOR LODE MINING CLAIM

NOTICE IS HEREBY GIVEN that the ARMORE # 113  
\_\_\_\_\_ lode mining claim has been located  
by EVERIM RESOURCES USA INC.,  
A NV CORPORATION whose current mailing  
address is 6121 LAKESIDE DRIVE, SUITE 260  
RENO, NV 89511

RECEIVED  
BLM AZ STATE OFFICE  
2015 JAN 21 A 9:06  
TUCUEN, ARIZONA  
BLM  
Date  
Stamp

The general course of this claim is NORTH-SOUTH and it is situated in PINAL  
County, Arizona. This claim is 1500 feet in length and 50 feet in width. This claim runs  
from the location monument on which this location notice is posted approximately 1480 feet in a  
NORTH direction to the NORTH end line and 20 feet in a SOUTH direction to the  
SOUTH end line. This claim is marked by six monuments, one at each corner and one at the center of each  
end line of the claim.

The location monument on which this notice is posted is situated within Section 15, Township 8  
S., Range 14 E., Gila Salt River Base and Meridian, Arizona and this claim encompasses portions  
of the following quarter section (s), section (s), Township (s) and Range (s) SW 1/4  
T. 8 S. R. 14 E. G & SRM.

Gila Salt River Base and Meridian, Arizona.

The locality of this claim with reference to some natural object or permanent monument and additional information  
(if any) concerning its locality are as follows: THE LOCATION MONUMENT BEARS N 1° 18' 40" E,  
805.81 FT. DISTANT FROM THE SW CORNER OF SECTION 15,  
T. 8 S. R. 14 E. G & SRM.

DATED AND POSTED on the ground this 10TH day of DECEMBER, 20 14.

LOCATOR (s) James A. Lapizza  
JAMES A. LAPUZZA, MS., RLS  
FOR EVERIM RESOURCES USA INC.

Form MCF100  
Revised July 2005

AMC430299

**MINING CLAIM MAP**

Lode (X) Placer ( )

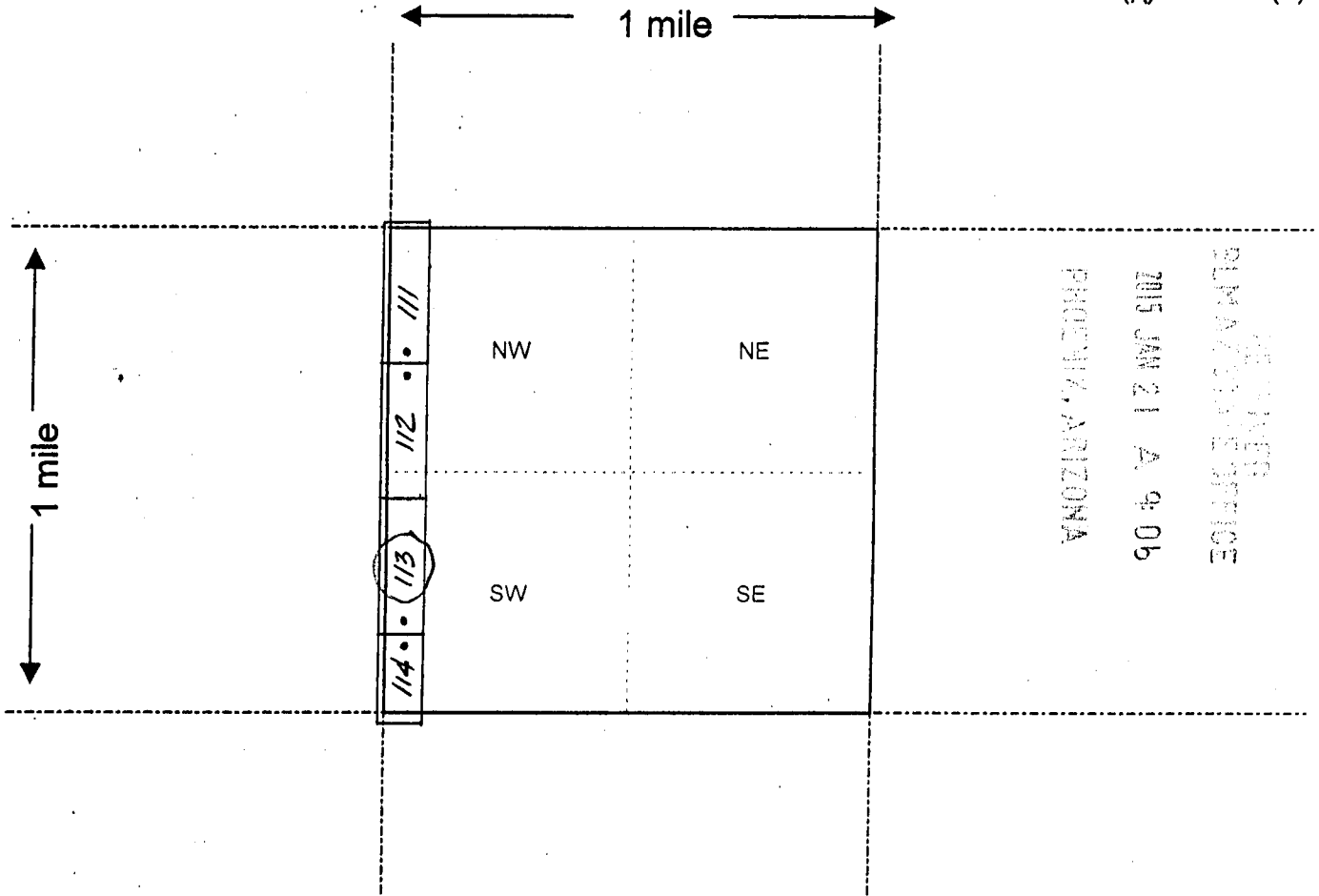

Scale : 1" = 2000 feet



1. The above map depicts the ARMORE # 113 mining claim, which is located in Section (8) 15, Township 8 S., Range 14 E., Gila and Salt River Base and Meridian, PINAL County, Arizona.

2. The type of corner and location monuments used are as follows: 2" x 2" WOOD POST WITH METAL IDENTIFICATION TAG

3. The bearings and distances in degrees and feet between claim corners are as depicted on the map.

Form MCF100a  
Revised July 2005

This form is available from the Arizona Department of Mines & Mineral Resources and may be reproduced.

(See Pg. 1)

AM0430299



**MINING CLAIM MAP**

Lode (X) Placer ( )

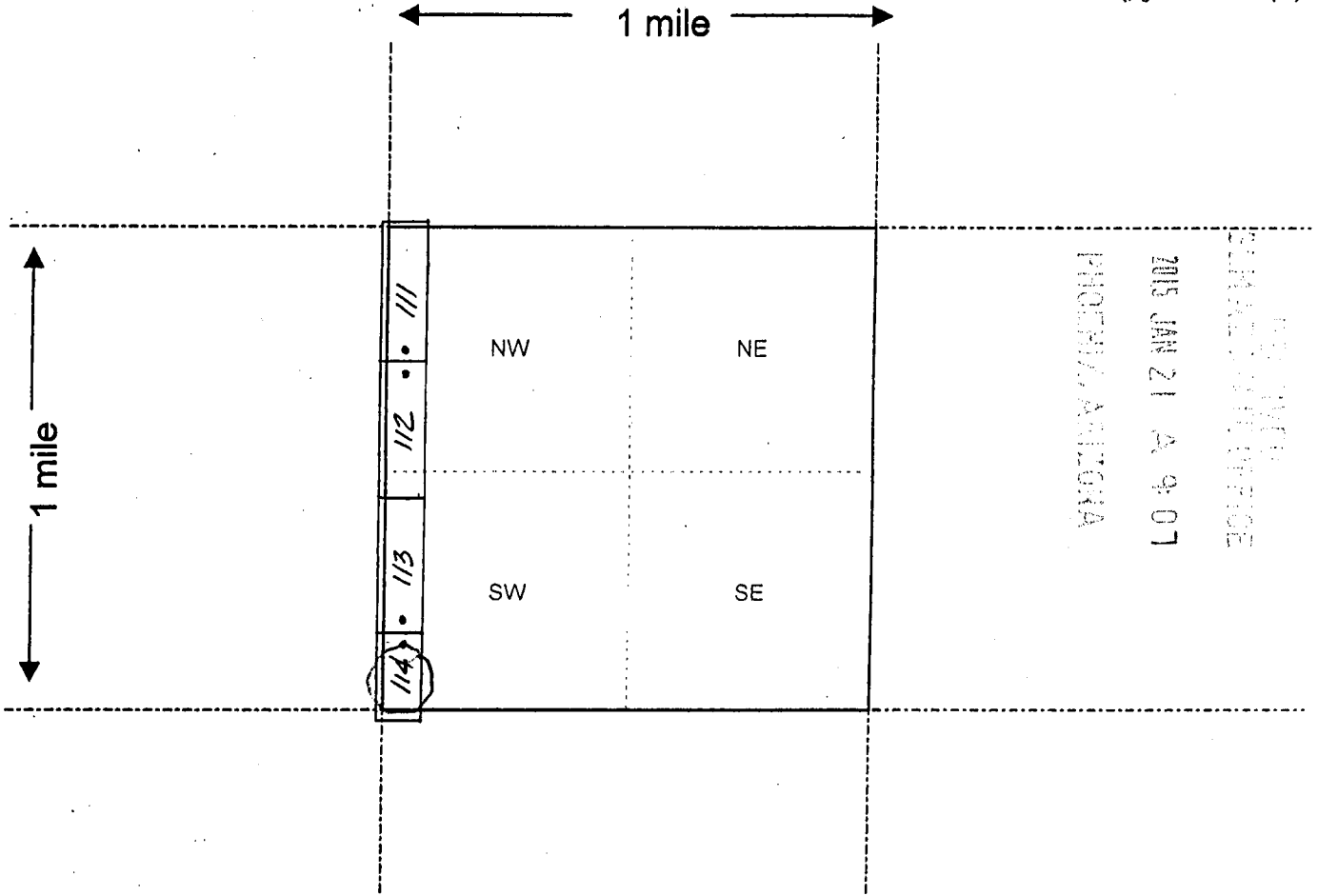

RECEIVED  
 CLAIMS SECTION  
 2015 JAN 21 A 9:07  
 PHOENIX, ARIZONA

AMC430300

Scale : 1" = 2000 feet



1. The above map depicts the ARMORE # 114 mining claim, which is located in Section (s) 15, Township 8 S., Range 14 E., Gila and Salt River Base and Meridian, PINAL County, Arizona.

2. The type of corner and location monuments used are as follows: 2" x 2" WOOD POST WITH METAL IDENTIFICATION TAG

3. The bearings and distances in degrees and feet between claim corners are as depicted on the map.  
 (SEE PG. 1)

Form MCF100a  
 Revised July 2005

This form is available from the Arizona Department of Mines & Mineral Resources and may be reproduced.

DEPARTMENT OF INTERIOR  
BUREAU OF LAND MANAGEMENT

Input Parameters for Geographic Report with Land

System Id = CR

Admin State = AZ

Geo State =

Casetype Begins With

Case Disp Txt = AUTHORIZED, CANCELLED, EXPIRED, PENDING, REJECTED, RELINQUISHED, WITHDRAWN

Mer Twp Rng =

Section =

Mtrs = 14 0080S 0140E 015, 14 0080S 0140E 999

Commodity =

Commodity Txt =

Pending Org =

Pend Org Decode =

Total Rows Returned: 3



RUN TIME: 11:24 AM

UNITED STATES DEPARTMENT OF INTERIOR  
BUREAU OF LAND MANAGEMENT  
GEOGRAPHIC REPORT WITH LAND  
Sorted by Serial Number

RUN DATE: 02/17/2015  
Page 1 of 1

Adm State: AZ

Serial Number: AZA 000889  
Total Case Acres: 16.370

<u>Casetype</u>	<u>Case Disp</u>	14	0080S	0140E	<u>Sect</u>	<u>Sur Typ</u>	<u>Sur Num</u>	<u>Suff</u>	<u>Subdivision</u>	<u>Act Pend</u>
288100	AUTHORIZED				015	MNR		1	E2E2W2;	

Serial Number: AZA 008778  
Total Case Acres: 457.280

<u>Casetype</u>	<u>Case Disp</u>	14	0080S	0140E	<u>Sect</u>	<u>Sur Typ</u>	<u>Sur Num</u>	<u>Suff</u>	<u>Subdivision</u>	<u>Act Pend</u>
285002	AUTHORIZED				015	ALIQ			W2;	

Serial Number: AZA 021397  
Total Case Acres: 18.180

<u>Casetype</u>	<u>Case Disp</u>	14	0080S	0140E	<u>Sect</u>	<u>Sur Typ</u>	<u>Sur Num</u>	<u>Suff</u>	<u>Subdivision</u>	<u>Act Pend</u>
282201	AUTHORIZED				015	ALIQ			W2;	

TOWNSHIP 8 SOUTH RANGE 14 EAST OF THE GILA AND SALT RIVER MERIDIAN, ARIZONA

PINAL COUNTY  
TUCSON FIELD OFFICE

STATUS OF PUBLIC DOMAIN  
LAND AND MINERAL TITLES

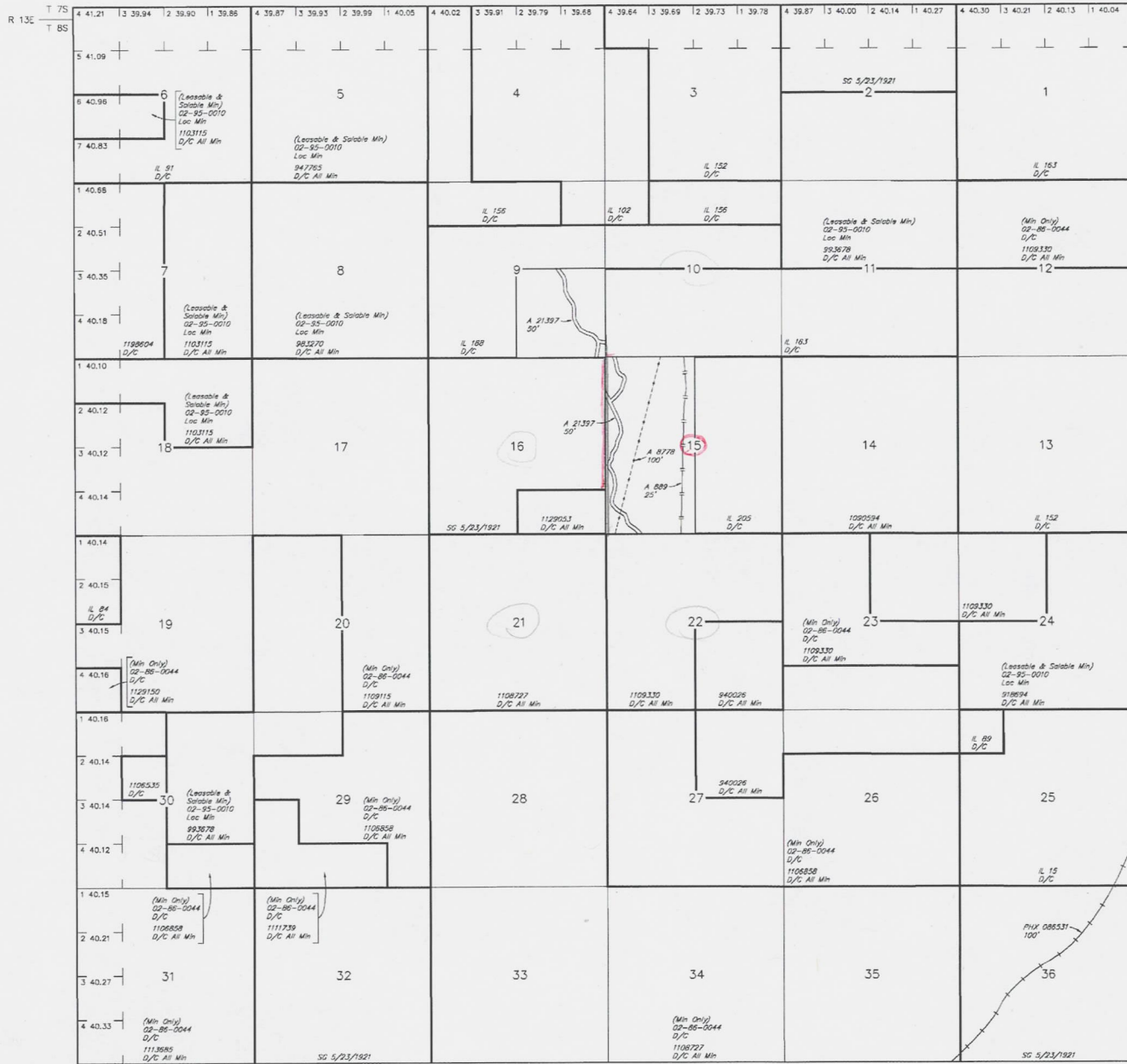

INDEX TO SEGREGATED TRACTS				
RESURVEY	ORIGINAL SURVEY			
TRACT NO	T	R	SEC	SUBDIVISION

FOR ORDERS AFFECTING DISPOSAL OR USE OF UNIDENTIFIED LANDS WITHDRAWN FOR CLASSIFICATION, MINERALS, WATER AND/OR OTHER PUBLIC PURPOSES, REFER TO INDEX OF MISCELLANEOUS DOCUMENTS.

PHX 082800 R/W Road  
Sec 17: NE1/4NE1/4SE1/4, SE1/4NE1/4, S1/2NE1/4SE1/4NE1/4

CURRENT TO	NW	GSR Mer
6-23-2011	ACAD	T 8 S
		R 14 E

Lat 32°41'06"N  
Long 110°50'23"W

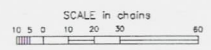

**WARNING STATEMENT**  
This plot is the Bureau's Record of Title and should be used only as a graphic display of the township survey data. Records hereon do not reflect title changes which may have been affected by lateral movements of rivers or other bodies of water. Refer to the coastal surveys for official survey information.